

MAP
of the
TOWN OF CLEVELAND,
Mesa County, Colorado
Scale: 200 ft = 1 inch.

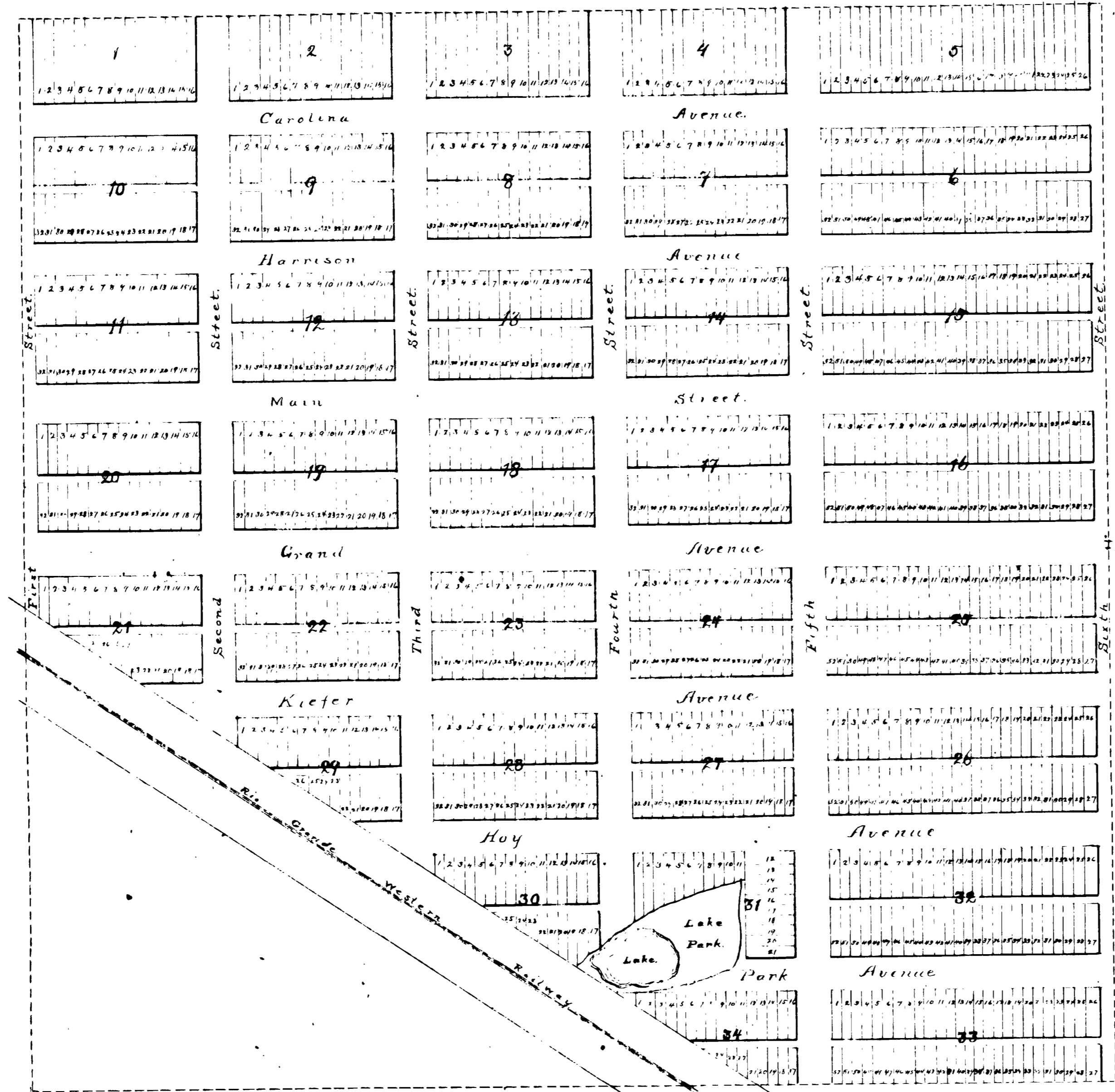

Know all men by these presents, that The Cleveland Town and Mercantile Company has laid out, platted and mapped all that portion of the South East quarter of Section Sixteen (16) Township One (1) North of Range Two (2) West 111. Mer. in the County of Mesa and State of Colorado lying north of the Rio Grande National Railway Company main railroad track as now constructed thro said quarter section; that said tract is laid out as appraised as the site of a town to be called The Town of Cleveland; that the said The Cleveland Town and Mercantile Company is the owner and proprietor of the tract so laid out and platted, and does by these presents forever dedicate to the public use the right of way over and thro all the streets and alleys shown in said plat.

In witness whereof the said The Cleveland Town and Mercantile Company has caused these presents to be signed by its President and attested by its Secretary and its corporate seal to be hereunto affixed this nineteenth day of November A.D. 1890.

The Cleveland Town and Mercantile Company
B. F. Kiefer Secretary
Joseph O. Kiefer its President

State of Colorado
Mesa County

On this 19th day of November A.D. 1890 before me came Joseph O. Kiefer, President of the Cleveland Town and Mercantile Company to me known to be the President of said Company and the identical person whose name is subscribed to the foregoing instrument as such President and acknowledged the foregoing plat and dedication to be his free and voluntary act as the President of said Company.

Witness my hand and official seal this nineteenth day of November A.D. 1890.

Address of the County Clerk
County Clerk



#10574
Nov 20 1890
A. J. McCune
1st Plat
20
A. J. McCune

MAP
of the
TOWN OF CLEVELAND,

Mesa County, Colorado
Scale: 200 ft = 1 inch.

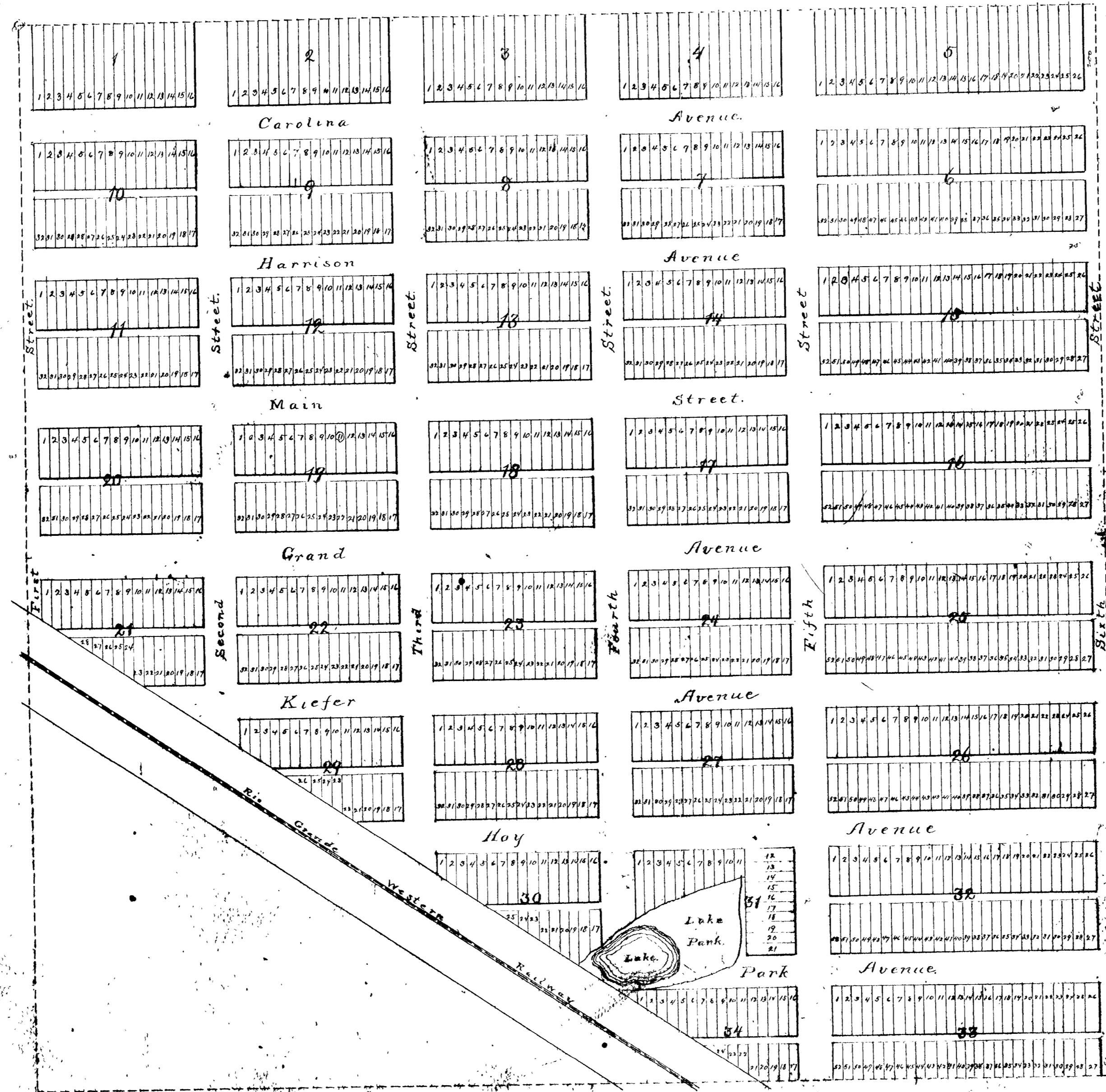

Know all men by these presents, that the Cleveland Town and Mercantile Company has laid out, platted and mapped all that portion of the South East quarter of Section 20, Township 31 North of Range Two West 10th Mer. in the County of Mesa and State of Colorado lying north of the Rio Grande National Railway Company's main railroad track as now constructed, this said quarter section; that said tract is laid out, as aforesaid as the site of a town to be called the Town of Cleveland; that the said Cleveland Town and Mercantile Company is the owner and proprietor of the lot so laid out and platted, and does by these presents forever dedicate to the public use the right of way over and thro' all the streets and alleys shown in said plat.

In Witness whereof the said The Cleveland Town and Mercantile Company has caused these presents to be signed by its President and attested by its Secretary and its corporate seal to be hereunto affixed this nineteenth day of November A.D. 1890

The Cleveland Town and Mercantile Company,
B. F. Kiefer Secretary by Joseph P. Kiefer its President

State of Colorado
Mesa County

On this 19th day of November A.D. 1890 before me came Joseph P. Kiefer, President of the Cleveland Town and Mercantile Company to me known to be the President of said Company and the identical person whose name is subscribed to the foregoing instrument as such President and acknowledged the foregoing plat and dedication to be his free and voluntary act as the President of said Company. Witness my hand and official seal this nineteenth day of November A.D. 1890.

Seal

Address of the Clerk
County Clerk

10574

State of Colorado, ss.
I, County Clerk, do hereby certify that this instrument was filed for record in my office, Nov. 20, 1890 at 11 o'clock A.M. and recorded in Book 1st Plat. p. 20.
G. J. McCann, Clerk